

# RENAULT DPO, PEUGEOT CITROEN AL4 4 SPEED FWD (Electronic Control)

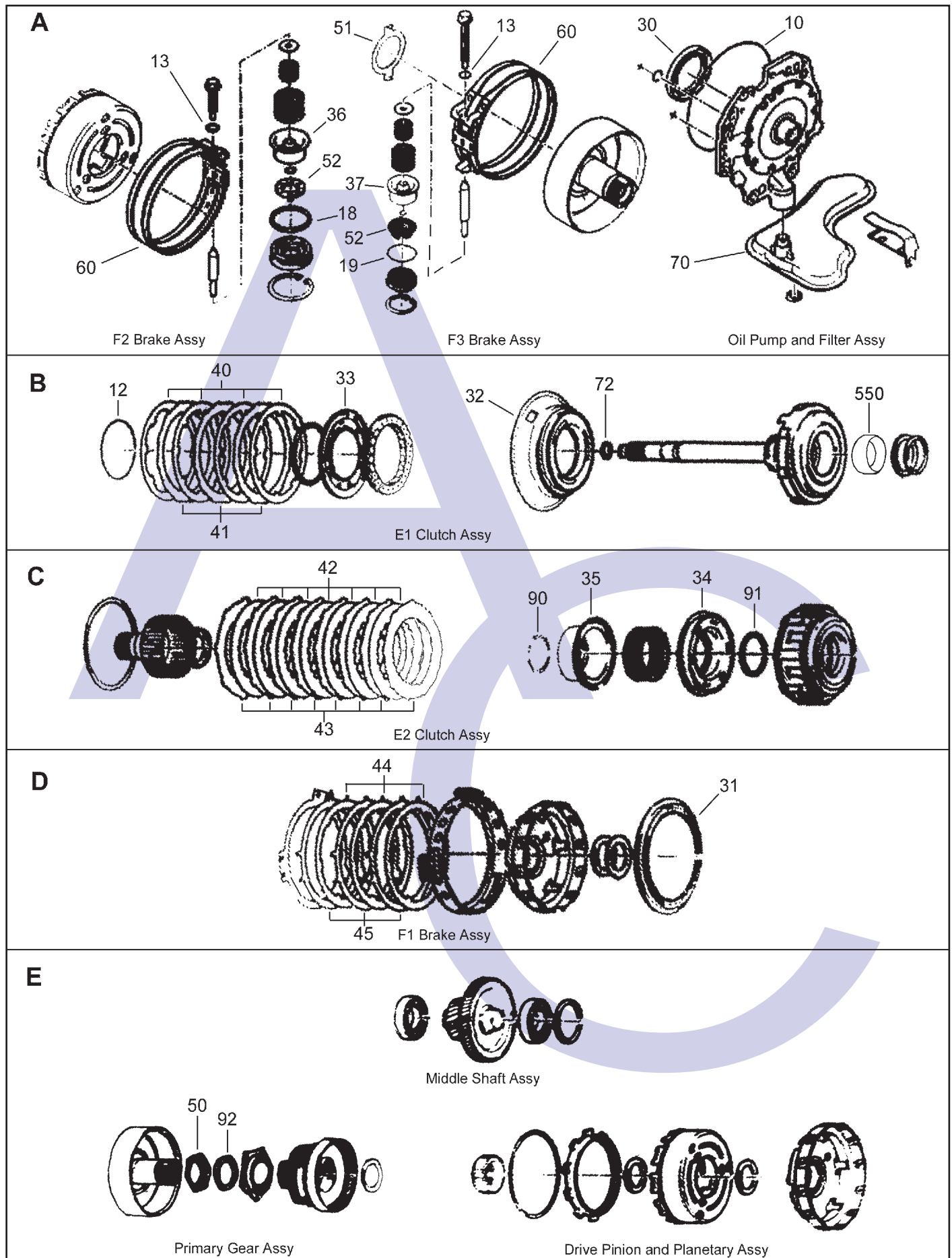

# RENAULT DPO, PEUGEOT CITROEN AL4

## 4 SPEED FWD (Electronic Control)

F

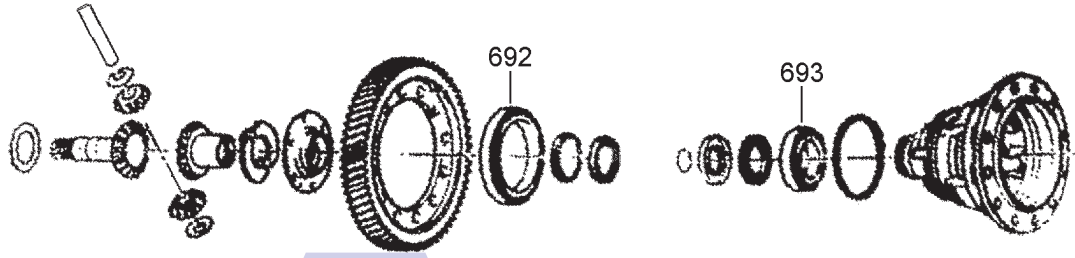

Differential Assy

G

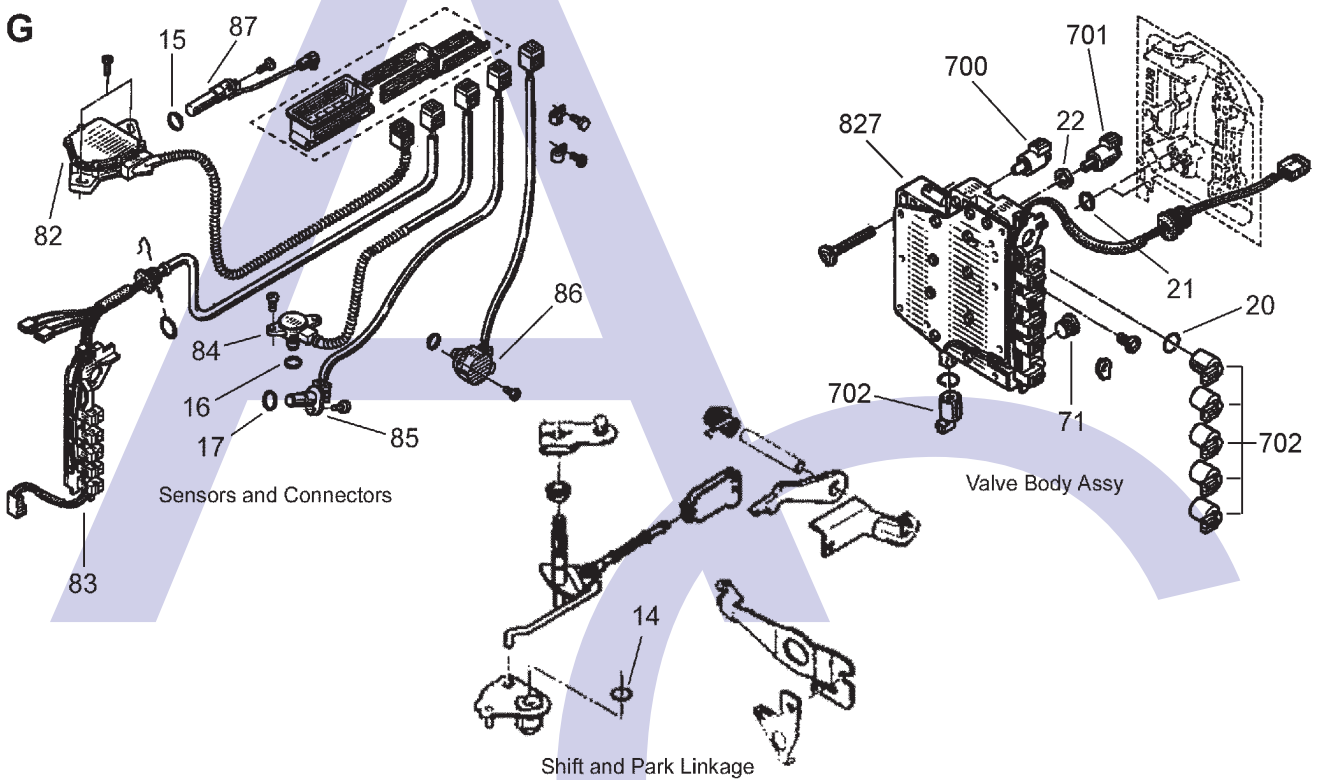

Sensors and Connectors

Valve Body Assy

Shift and Park Linkage

H

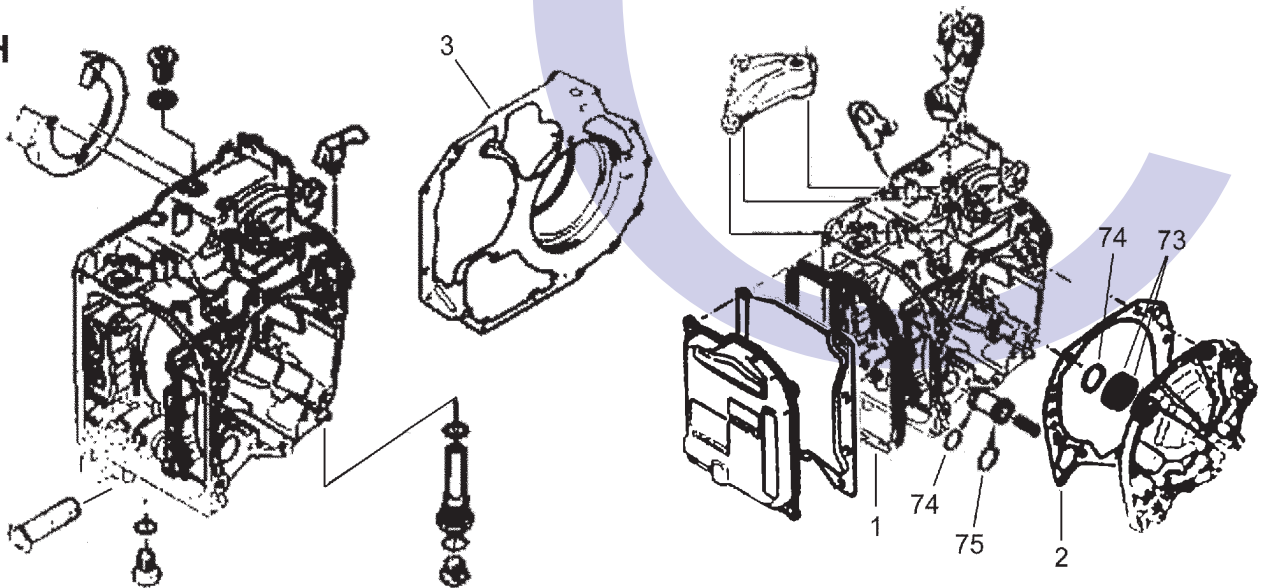

Transmission Casing

# RENAULT DPO, PEUGEOT CITROEN AL4

## 4 SPEED FWD (Electronic Control)

ILL NO.	DESCRIPTION	YEARS	QTY	PART NO
<b>KITS</b>				
Kit	Gasket and Seal .....	All	1	DPO.GSK01
Kit	Overhaul Kit (EOM) Without Metal Gaskets.....	All	1	DPO.OHK01
Kit	Overhaul Kit (Transtec) Without Metal Gaskets.....	All	1	DPO.OHK04
Kit	Overhaul Kit (Precision) Without Metal Gaskets.....	All	1	DPO.OHK51
Kit	Piston Kit.....	All	1	DPO.PISKIT
Kit	Copper Washer Kit.....	All	1	DPO.WK01
Kit	'O' Ring Kit.....	All	1	DPO.ORK01
<b>GASKETS</b>				
1H	Valve Body Cover .....	All	1	DPO.GAS01
2H	Rear Cover (Steel & Rubber)....	All	1	DPO.GAS02
3H	Metal Case Gasket (?????).....	All	1	DPO.GAS03
3H	Metal Case Gasket (Citroen) (Use With DPO.GAS06) .....	All	1	DPO.GAS05
3H	Late Case Gasket Bowl (Citroen) (Use With DPO.GAS05) .....	All	1	DPO.GAS06
<b>RUBBER COMPONENTS</b>				
10A	Pump 'O' Ring.....	All	1	DPO.OR01
NI	Pump Bolt 'O' Ring.....	All	10	DPO.OR02
12B	'E1' 'O' Ring .....	All	1	DPO.OR03
13A	Band Bolt 'O' Ring.....	All	2	DPO.OR04
14G	Detent Selector 'O' Ring .....	All	1	DPO.OR05
14G	Sensor 'O' Ring (Output Speed Sensor).....	All	1	DPO.OR06
16G	Sensor 'O' Ring (Oil Pressure Sensor) .....	All	1	DPO.OR07
17G	Sensor 'O' Ring (Input Speed Sensor).....	All	1	DPO.OR08
18A	'F2' Servo 'O' Ring .....	All	1	DPO.OR09
19A	'F3' Servo 'O' Ring .....	All	1	DPO.OR10
20G	Shift Solenoid 'O' Ring.....	All	6	DPO.OR11
NI	Speedo 'O' Ring.....	All	1	DPO.OR12
NI	Solenoid Loom 'O' Ring .....	All	1	DPO.OR13
NI	Heat Exchanger Seal (Outer) ...	All	1	DPO.SQR01
NI	Heat Exchanger Seal (Inner) ....	All	1	DPO.SQR02
21G	Valve Body to Case Seal .....	All	2	DPO.SQR03
22G	EPC Solenoid Seal .....	All	2	DPO.SQR04
<b>METAL CLAD SEALS</b>				
30A	Converter Seal.....	All	1	DPO.MCS01
NI	Driveshaft (Left Hand).....	All	1	DPO.MCS02
NI	Driveshaft (Right Hand) .....	All	1	DPO.MCS03
NI	Selector Shaft .....	All	1	DPO.MCS04
<b>PISTONS</b>				
Kit	Piston Kit.....	All	1	DPO.PISKIT
31D	'F1' Moulded Piston .....	All	1	DPO.PIS01
32B	'E1' Moulded Piston .....	All	1	DPO.PIS02
33B	'E1' Accumulator Piston .....	All	1	DPO.PIS04
34C	'E2' Moulded Piston .....	All	1	DPO.PIS05
35C	'E2' Accumulator Piston .....	All	1	DPO.PIS03
36A	'F2' Servo Piston (65.00 x 24.40mm).....	All	1	DPO.SER02
37A	'F3' Servo Piston (46.00 x 23.50 x 8.00mm).....	All	1	DPO.SER03

ILL NO.	DESCRIPTION	YEARS	QTY	PART NO
<b>FRICTION/STEEL PLATES</b>				
Kit	Friction Kit.....	All	1	DPO.FRK01
Kit	Friction Kit (Alto) .....	All	1	DPO.FRK51
40B	'E1' 160 x 120 x 1.60mm (8 Internal Teeth).....	All	3	DPO.FRP01
40B	'E1' 160 x 120 x 1.60mm (8 Internal Teeth) (Allomatic).....	All	3	DPO.FRP11
41B	'E1' 165 x 133 x 1.60mm (12 External Teeth) .....	All	3	DPO.FRP02
41B	'E1' 165 x 133 x 1.60mm (12 External Teeth) (Allomatic) .	All	3	DPO.FRP12
41B	'E1' 165 x 133 x 1.60mm (Early 12 External 15.7mm Teeth)		3	DPO.FRP07
42C	'E2' 118 x 78 x 1.60mm (20 Internal Teeth).....	All	7	DPO.FRP03
42C	'E2' 118 x 78 x 1.60mm (20 Internal Teeth) (Allomatic)...	All	7	DPO.FRP13
43C	'E2' 124 x 82 x 1.60mm (8 External Teeth) .....	All	7	DPO.FRP04
43C	'E2' 124 x 82 x 1.60mm (8 External Teeth) (Allomatic) ...	All	7	DPO.FRP14
44D	'F1' 171 x 137 x 1.60mm (6 Internal Teeth).....	All	3	DPO.FRP05
44D	'F1' 171 x 137 x 1.60mm (6 Internal Teeth) (Allomatic).....	All	3	DPO.FRP15
45D	'F1' 199 x 146 x 1.60mm (6 External Teeth) .....	All	3	DPO.FRP06
45D	'F1' 199 x 146 x 1.60mm (6 External Teeth) (Allomatic) ...	All	3	DPO.FRP16
<b>THRUST WASHERS AND BEARINGS</b>				
Kit	Selective Thrust Kit ( 'F2'/'F3' Servo).....	All	1	DPO.TWK02
50E	Hexagonal Nut Thrust.....	All	1	DPO.THW01
51A	Plastic Thrust Washer (2 Tang 63 x 48mm).....	All	1	DPO.THW02
52A	'F3' & 'F3' Selective Thrust Kit ..	All	1	DPO.THW03
<b>BANDS</b>				
60A	'F2' & 'F3' Band (OEM) .....	All	2	DPO.BAN01
60A	'F2' & 'F3' Band (Pattern)) .....	All	2	DPO.BAN02
<b>FILTERS</b>				
70A	Pan Filter .....	All	1	DPO.FIL01
71G	Valve Body Filter.....	All	1	DPO.FIL02
<b>SHAFT SEALING RINGS</b>				
Kit	Shaft Sealing Ring Kit.....	All	1	DPO.SRK01
72B	Input Shaft (18.00 x 1.80 x 1.75mm).....	All	1	DPO.SSR01
73H	Rear Cover (Outer) (Transtec) (54.00 x 50.00 x 2.00mm).....	All	2	DPO.SSR02
73H	Rear Cover (Outer) (OEM) (54.00 x 50.00 x 2.00mm).....	All	2	DPO.SSR12
74H	Rear Cover (Inner) (32.50 x 28.50 x 2.00mm).....	All	1	DPO.SSR03
74H	Accumulator (Inner) (32.50 x 28.50 x 2.00mm).....	All	2	DPO.SSR03
75H	Accumulator (Outer) (25.00 x 21.00 x 2.00mm).....	All	1	DPO.SSR04

# RENAULT DPO, PEUGEOT CITROEN AL4 4 SPEED FWD (Electronic Control)

ILL NO.	DESCRIPTION	YEARS	QTY	PART NO
<b>BUSHES &amp; BEARINGS</b>				
550B	'E1' Clutch Drum Bushing .....	All	1	DPO.BUS02
NI	Pump Bush (Standard) .....	All	1	DPO.BUS01
NI	Pump Bush (Oversize).....	All	1	DPO.BUS03
NI	Bush, Pump Stator (Small) .....	All	1	DPO.BUS04
NI	Bush, Pump Stator (Large) .....	All	1	DPO.BUS05
692F	Diff Bearing L/H .....	All	1	DPO.BE02
693F	Diff Bearing R/H .....	All	1	DPO.BE01
693F	Bearing-Diff R/H (Update) (41mm x 72mm x 15.50mm).....	All	1	DPO.BE03
<b>VALVE BODY COMPONENTS</b>				
NI	Plastic Valve Body Plug Set.....	All	1	DPO.VA01
<b>ELECTRICAL COMPONENTS</b>				
700G	EPC Solenoid ( <b>NLA See Note</b> ) -09/03		1	DPO.SOL01
700G	EPC Solenoid ( <b>See Note</b> ).....	10/03-	1	DPO.SOL03
701G	Lock Up Sol ( <b>NLA See Note</b> ) ... -09/03		1	DPO.SOL01
701G	Lock Up Sol ( <b>See Note</b> ).....	10/03-	1	DPO.SOL03
702G	Shift Solenoid.....	All	6	DPO.SOL02
82G	Range Switch (Megane, Clio & Scenic) .....	All	1	DPO.ELE01
83G	Valve Body Loom (Megane, Clio & Scenic) .....	All	1	DPO.ELE02
84G	Pressure Sensor (Megane, Clio & Scenic) .....	All	1	DPO.ELE03
84G	Pressure Sensor (Citroen).....	All	1	DPO.ELE11
85G	Input Speed Sensor (Megane, Clio & Scenic) .....	All	1	DPO.ELE04
86G	Heat Exchanger Temp Sensor..	All	1	DPO.ELE05
87G	Output Speed Sensor .....	All	1	DPO.ELE06
<b>Renault DPO, Peugeot &amp; Citroen AL4 Pressure and Lock-Up Solenoids</b>				
<p>The <b>DPO.SOL03</b> solenoid is the latest design type (Silver with black connector), this supersedes the earlier design <b>DPO.SOL01</b> with white connector which is no longer available. When replacing solenoids of the previous design, both the lock-up and the pressure regulating solenoid must be replaced together and vehicle returned to the dealer to have the ECU reprogrammed. This is necessary because the pulse width modulation frequency is different on the later design. Approximate dates of changeover to the new design are as follows: Megane 2, September 2003, Laguna Jan 2004 &amp; all other models from March 2004, Peugeot &amp; Citroen Models from September 2003.</p>				
<b>HARD PARTS</b>				
90C	'E2' Upper Circlip (47.00 x 40.00 x 1.50mm).....	All	1	DPO.CIR01
91C	'E2' Drum Retainer Circlip (46.00 x 47.00 x 2.00mm).....	All	1	DPO.CIR02
92E	Nut (Primary Gear Assy) (125.00 x 54.00 x 7.00mm).....	All	1	DPO.NUT01
827G	Valve Body Assy (Exchange) With Early Solenoids (Renault) <b>Can be fitted to Citroen/Peugeot if seperator plate is changed.....</b>	All	1	DPO.VB01
827G	Valve Body Assy (Exchange) With Late Solenoids (Renault) <b>Can be fitted to Citroen/Peugeot if seperator plate is changed.....</b>	All	1	DPO.VB02

ILL NO.	DESCRIPTION	YEARS	QTY	PART NO
<b>SUNDRY ITEMS</b>				
NI	Washer Cooler Bolt (Copper/Rubber).....	All	1	DPO.WA01
NI	Heat Exchanger (Megane).....		1	DPO.COOL01
<b>TOOLS AND MANUALS</b>				
NI	Selector Detent Setting Tool .....	All		DPO.TOOL01
NI	R/H Drive Shaft Seal Installer... All			DPO.TOOL02
NI	L/H Drive Shaft Seal Installer.... All			DPO.TOOL03
NI	Pump Seal Installer..... All			DPO.TOOL04
NI	Adapter Plate Centralising Tool All			DPO.TOOL05